

# INSTRUCTIONS

Self priming pump execution standard : JB/ TI0601·2006 Please read this manual carefully before using the product. If you have any questions, please refer to the manual or call the manufacturer.



**Smart self-priming pump 3 in 1  
for cold and hot water**



Before starting installation, please read the manual carefully. Please pay attention to the safety warning signs and all content. The manufacturer shall not bear any liability or compensation for any personal injury, pump injury or other property damage caused by failure to comply with the instructions marked on the safety warning signs and to operate in accordance with regulations.

### [1] Product function overview

Smart self priming pump has functions:

- 1, Intelligent mode ;
- 2, Manual mode ;
- 3, Timing pattern ;
- 4\_ Water shortage protection
- 5, Over-current protection ;
- 6, Lightning protection ;
- 7, Electrified delay;
- 8, Water shortage detection

This series of electric pumps has both high suction and lift.

Widely used for domestic water supply, irrigation, tap water pressurization, well water pumping, water pressure boosting, timed cistern filling, multi-level water supply, water recirculation systems (such as pure water and heating and cooling closed loops) and with specific industry equipment (air energy, solar energy, water heating, purified water, etc.)

### [2] Conditions of use

1. The liquid medium temperature tolerance is 0 - 100 degrees Celsius (32 - 212 degrees Fahrenheit). Suitable for clean, noncorrosive mediums which do not contain solid particles or fibers. Not suitable for flammable, explosive, or gasifiable liquid.
2. The pH value tolerance is between 6.5-8.

### [3] Keystrokes and indicator lights

1. Smart Mode / Reset button : Comes factory set in constant pressure (Smart) mode. Press this button to reset to factory settings and re-enter the Smart Mode or in case of a water shortage fault (Water shortage indicator lights up to protection the pump.)

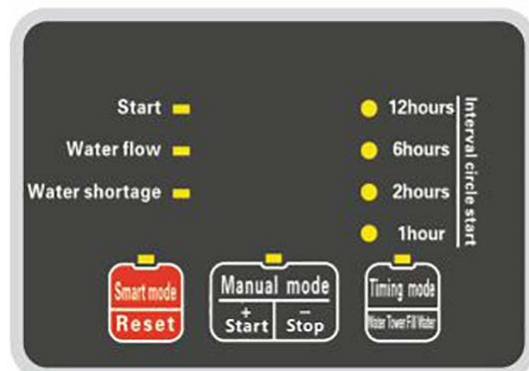

2. Manual key : Frequent priming caused by special pipelines (such as short pipelines and serious leakage). You can take manual intervention. Pressing "Stop-" can reduce frequent start times or stop shutting down when the valve is closed. Press "Start+" to interfere with the opening of the valve.
3. Timing key : Use for irrigation, circulation or filling of tanks. Press this button repeatedly to set the desired run time. (1 hour, 2 hours, 6 hours, 12 hours) The pump will run for the desired time and then shut-down. The automatic cycle will start again after the desired interval.

- 4、 Flow indicator light :When water flows through the pump body, the light will illuminate. If the flow is restricted by a foreign object or is jammed, the valve is closed and the light is illuminated. Remove the flow sensor, clean it, and reinstall.
- 5、 Water shortage lamp : Prime the pump. Restore the water flow. Press the reset button.

**[5] When installing the inlet and outlet piping:**

- 1、 The diameter of the outlet pipe should be the same size or larger than the diameter of the outlet pipe to prevent pressure drop, and excessive noise and to prevent water shortage faults.
- 2、 Do not use soft or flexible tubing that can be crushed for the intake line and to avoid collapse due to vacuum pressure.
- 3、 Install the suction line at least 6 inches off the bottom of the water source to avoid drawing sediment up into the pump.
- 4、 All inlet pipe and fittings must be properly sealed to prevent vacuum leaks and you should minimize the use of unnecessary fittings and elbows to improve water flow.
- 5、 Installed the pump as close as possible to the well or water supply. It is easier to for the pump to push water than it is to suck the water.

	<p>Please follow this manual strictly. Check the insulation resistance or all wiring carefully before energizing to prevent damage. The electric pump should be properly grounded, and proper circuit protection should be installed. After powering the pump on, do not touch the electrical connections. Avoid contact with standing water that could come into contact with the electrical components of the pump to avoid electric shock. Always disconnect the power source before opening the pump to repair it.</p>
------------------------------------------------------------------------------------	----------------------------------------------------------------------------------------------------------------------------------------------------------------------------------------------------------------------------------------------------------------------------------------------------------------------------------------------------------------------------------------------------------------------------------------------------------------------------------------------------------------------------

**[6] Other points for attention**

- 1、 ① Always disconnect the power source when installing and performing maintenance on the pump. The pump should be properly grounded. To prevent electric shock, please install with proper ground fault protection. If the plug is wet you can be shocked when you touch it. Please be careful,
- ② No flammable products should be stored within 3 feet of the water pump, to avoid fire and ensure proper pump ventilation.
- ③ When the pump is installed outdoors, provide suitable shelter to prevent wind and rain and avoid direct sunlight when possible, to extend the life of the pump.
- 2、 If problems with the pump arise, such as abnormal sound, low water pressure, or intermittent water flow, immediately cut off the power supply, inspection, and troubleshoot the issue. In high humidity and wet locations, do not touch the electric pump while the power supply is connected to avoid possible shock. Avoid splashing water on the pump with pressure and do not submerge the pump in water.
- 3、 ① Do not allow the pump to freeze. Make sure that frost prevention measures are taken to prevent the pump from damage. Winterize the pump by removing the bolts and emptying all of the liquid in the pump to prevent freezing and cracking.
- ② If the pump will not be in use for a long time, turn off the pump inlet and outlet valve and turn off the power to the pump. When restarting the pump make sure the impeller turns freely before running the pump.

### [7] Electrical connection

Make all electrical connection and ground fault protection according to local codes and regulations. The nameplate contains the voltage and other specifications. Always match the power supply. For 3 phase power systems:

Check whether the pump is runs properly, and rotates correctly. This can be seen from the rear cover. Clockwise rotation of the fan indicates that the pump is running in the correct direction. If the rotation is not correct, disconnect the power supply and exchange two power supply leads.

### [8] Parts Diagram

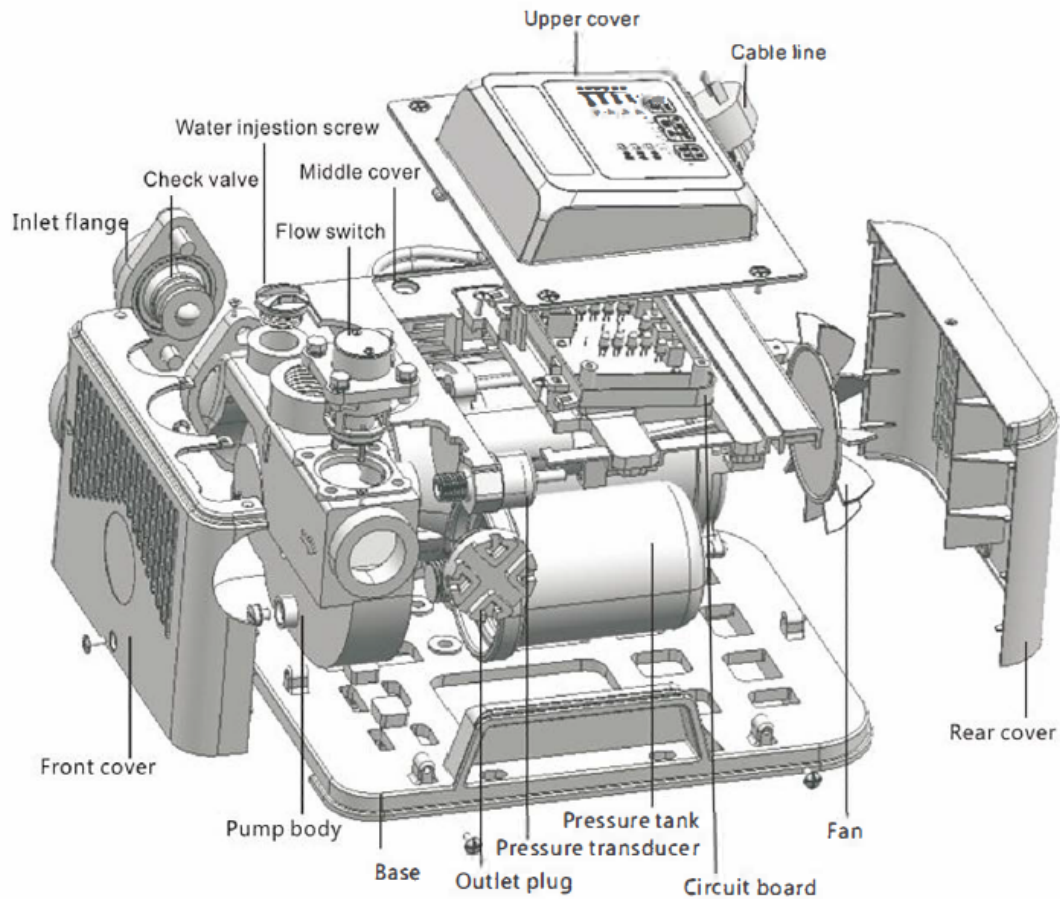

## Troubleshooting

<b>Fault</b>	<b>Reason</b>	<b>Solutions</b>
Pump Will Not start	The water shortage indicator flickers and enters the water shortage state.	Prime the pump. Confirm that water is flowing to the inlet of the pump. Press reset button.
	Pressure fluctuation or incorrect voltage.	Check power supply. Press manual "Start+" button.
Pump will not stop running	When the valve is closed, the flow indicator is bright.	Remove flow sensor/switch. Carefully clean and remove debris, then reinstall.
	Pressure fluctuation	Press " Stop- " manually.
Pump turns on and off frequently.	Pump is in "Smart" constant pressure mode. Check valve is damaged or clogged. There is a leak.	To maintain constant pressure the pump must start and stop frequently.
		Pipeline is air-locked or pipeline is unable to maintain pressure.
		Fix leak. For low water usage or slow leaks, press the manual " Stop- " button to reduce frequent start times.
Low water pressure	Incorrect pump	Refer to pump specifications.
	Distance to water supply is too far or goes through too many turns or too much lift.	Make sure inlet pipe size is correct and has minimal bends, adequate check valves, and minimal lift.
	Foreign matter obstructs inlet pipe, filter screen or pump chamber.	Clean pipe, bottom valve or pump chamber, remove debris.
	The motor voltage is too low or the power run is too long.	Check motor terminal voltage and use proper wire size.
The motor runs but does not move water	The pump is not filled with water.	Prime the pump.
	Impeller damage	Replacement of impeller (See your dealer)
	Water level below bottom valve	Adjust inlet line or lower water pump below source water level.
	Suction pipe leakage	Repair vacuum leaks in the suction pipe.
	The water level is too low, which is lower than the limit suction of the pump.	Adjust pump installation height or select a suitable pump.



<b>Fault</b>	<b>Reason</b>	<b>Solutions</b>
The motor has loud or abnormal sound.	Impeller and pump body stuck	Turn off electricity first. Use a screwdriver to turn the blade through the rear body cover. Or open the impeller of the pump head.
	The shaft and bearing are stuck.	Replace bearing. (See your dealer)
	There is a circuit break in the main and secondary windings.	Check motor. Replace. (See your dealer)
The motor has power but won't start	Capacitor failure	Replace the capacitor.
	Clean or replace the check valve.	Check motor
	Burn out of PCB	Disconnect the circuit board and test to see if the motor is running normally.
Motor burn out	Impeller jammed or overloaded for a long time	Clear the pump cavity, and inspect/replace the impeller and motor.
Seal water leakage	Mechanical seal worn from impurities	Clean or replace mechanical seals

Note: To improve product performance, technical specifications are subject to change without prior notice.



## **EZ RED STAINLESS STEEL BOOSTER PUMP**

Congratulations! You have purchased one of the finest Smart Self-Priming EZ Red Pump available! In the unlikely event of a problem due to defects in material and workmanship, we proudly warranty our EZ Black Booster Pump to the original owner, at the original installation location, when installed within recommended parameters from the date of original installation as follows:

**For a period of 90 DAYS: For the entire EZ Red Pump, if registered. NO WARRANTY WILL BE APPLIED IF NOT REGISTERED.**

**ALL PUMPS MUST BE REGISTERED AT THE TIME OF INSTALLATION BY GOING TO:  
[www.coastalwaterfilters.com/product-registration](http://www.coastalwaterfilters.com/product-registration) and filling out the required information.**

Any part found defective within the terms of this warranty will be repaired or replaced by the dealer at the manufacturer's discretion. You pay only freight from our factory and local dealer charges. To obtain local warranty service, contact your original dealer. If original dealer is unknown, contact Coastal Water Filters for authorized service dealer in your area. If no authorized dealer is located in your area, please obtain a Return Merchandise Authorization (RMA) by contacting customer service at +1-239-398-7651 and then ship the defective part or component freight prepaid to:

Coastal Water Filters,  
Inc. 435 23rd St. NW  
Naples, Florida 34120

Coastal Water Filters, at its discretion, will repair or replace the part or component at its expense and return part freight collect.

Our product performance specifications are furnished with each pump. The above provisions of the warranty are valid as long as the pump is connected in compliance with local plumbing codes and in an equivalent manner and condition of the original installation and is owned by the original owner. We do not know the characteristics of your water supply or the purpose for which you are purchasing this pump. Please understand that the quality of water supplies may vary seasonally or over a period of time, and that your water usage rate may vary as well.

This warranty does not cover damages due to accident, fire, flood, freezing, or any other Act of God. CWF is not responsible for damages due to change in water conditions, misapplication, misuse, neglect, vacuum, oxidizing agents, alteration, or lack of maintenance. No responsibility is assumed for loss of use of the pump, inconvenience, loss or damage to real or personal property or any incidental or consequential damages. Furthermore, we assume no liability and extend no warranties, express or implied, for the use of this product with a non-potable water source.

**To the extent permitted by law, CWF disclaims all implied warranties, including without limitation warranties of merchantability and fitness for particular purpose; to the extent required by law, any such implied warranties are limited in duration to the aforementioned period specified above.**

Some states do not allow limitations on how long an implied warranty lasts, so the above limitation may not apply to you. Some states do not allow the exclusion or limitation of incidental or consequential damages, so the above limitation or exclusion may not apply to you. This warranty gives you specific legal rights, and you may also have other rights which vary from state to state.







# Ozmosis EZ Red Pump

MODEL #: \_\_\_\_\_

SERIAL #: \_\_\_\_\_

INVOICE #: \_\_\_\_\_

HP: \_\_\_\_\_ VOLT: \_\_\_\_\_

DATE: \_\_\_\_\_



**COASTAL WATER FILTERS**  
WHOLESALE ONLY



## Ozmosis

Manufactured by:  
Coastal Water Filters, Inc  
435 23rd St. NW  
Naples, FL 34120  
Phone: 239-398-0967  
E-mail: [info@coastalwaterfilters.com](mailto:info@coastalwaterfilters.com)

